



LILY 1 LED DOWNLIGHTER

Installation instructions



**Innovation.
Collaboration.
Illumination.**

LILY 1 - LED DOWNLIGHTER

Installation instructions

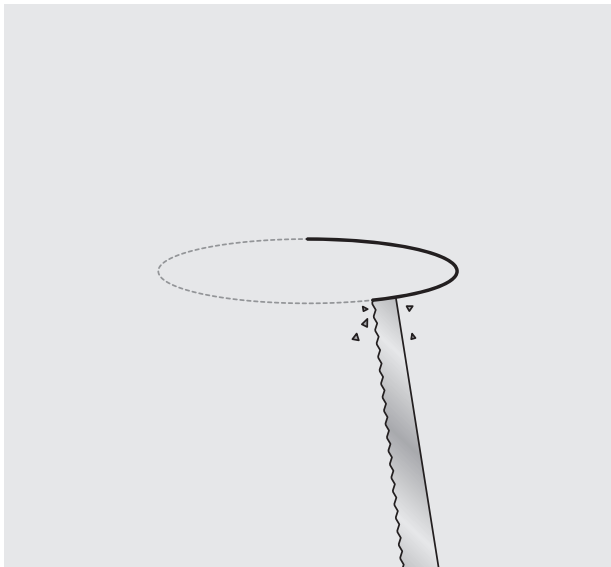

Cut Ø72mm hole in the ceiling.

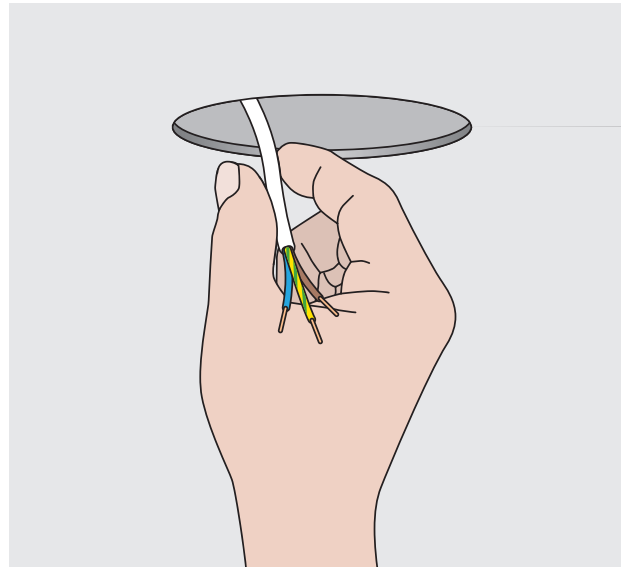

Pull the cable through the hole and connect to the driver.

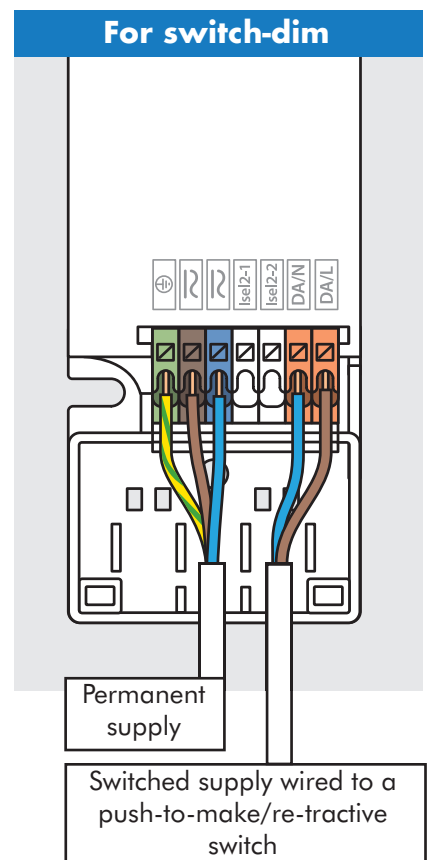
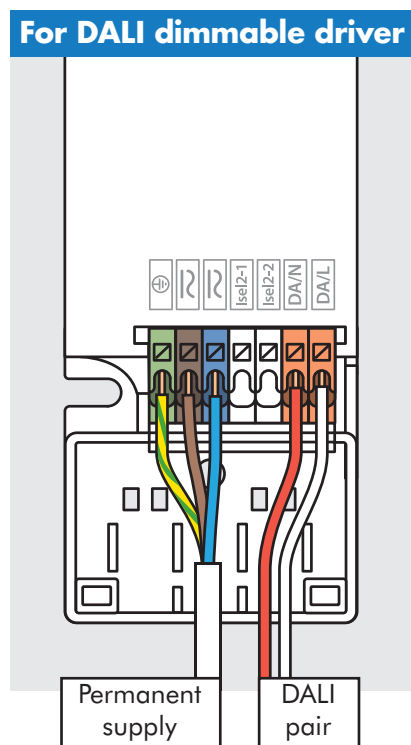
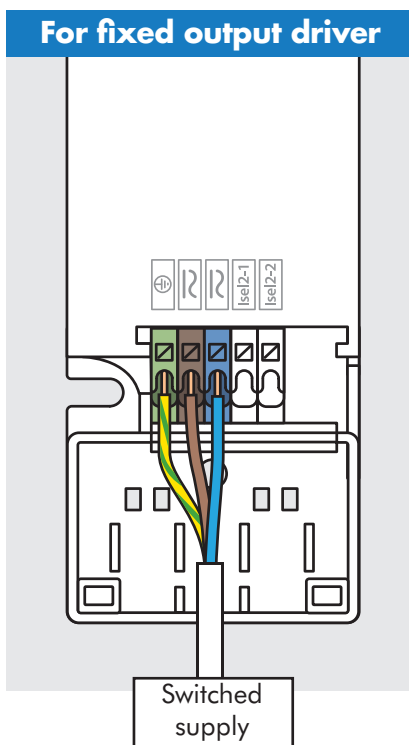

LILY 1 - LED DOWNLIGHTER

Installation instructions

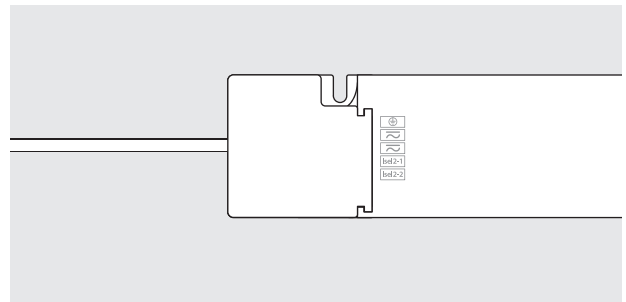
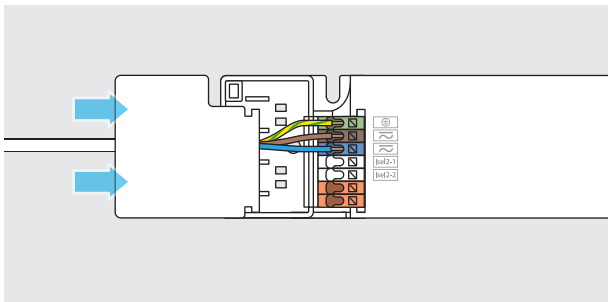

Clip on any strain relief clips and terminal cover/lid.

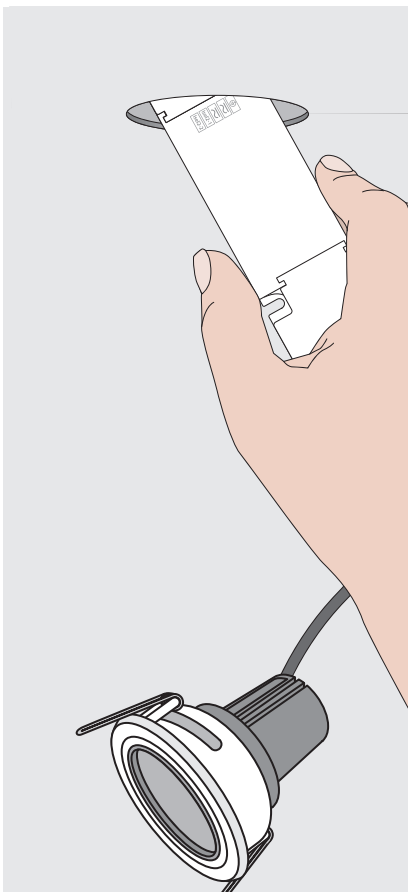

Insert the driver and the back of the downlight through the Ø72mm hole.

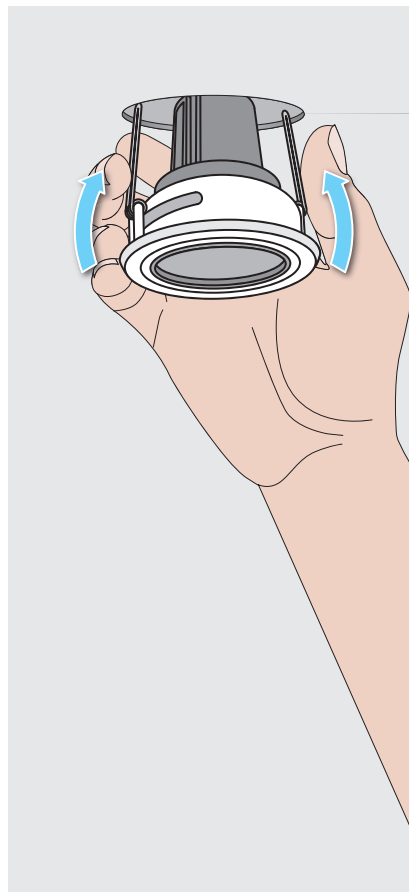

Squeeze springs upwards and push in to the ceiling.

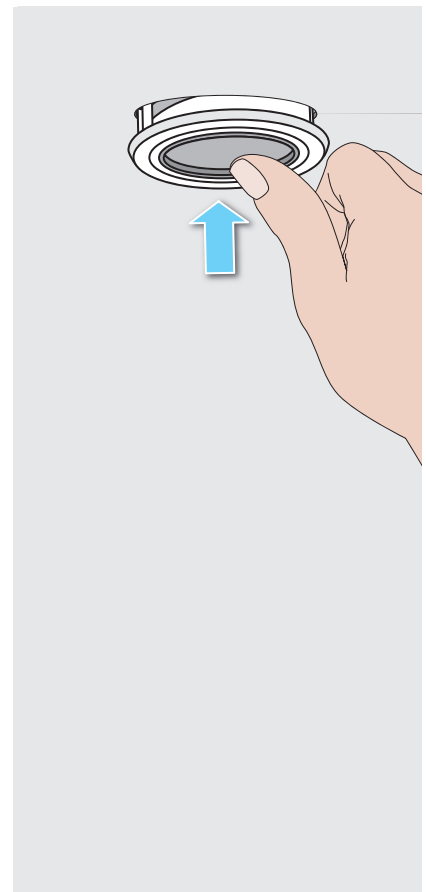

Push Lily 1 until fully installed.

Innovation.
Collaboration.
Illumination.

