



## **MILLIE** LINEAR LED LUMINAIRE

### **Installation instructions** **RECESSED**

MIL/*05/****	L = 570mm
MIL/*08/****	L = 850mm
MIL/*11/****	L = 1130mm
MIL/*14/****	L = 1410mm
MIL/*16/****	L = 1690mm
MIL/*19/****	L = 1970mm
MIL/*22/****	L = 2250mm

Innovation.  
Collaboration.  
Illumination.





## Recessed

**Cut ceiling only when Millie luminaires are on site to double check sizes.**

65mm x (millie length + 10mm)  
ie. for 1690mm Millie cut hole **65mm x 1700mm**

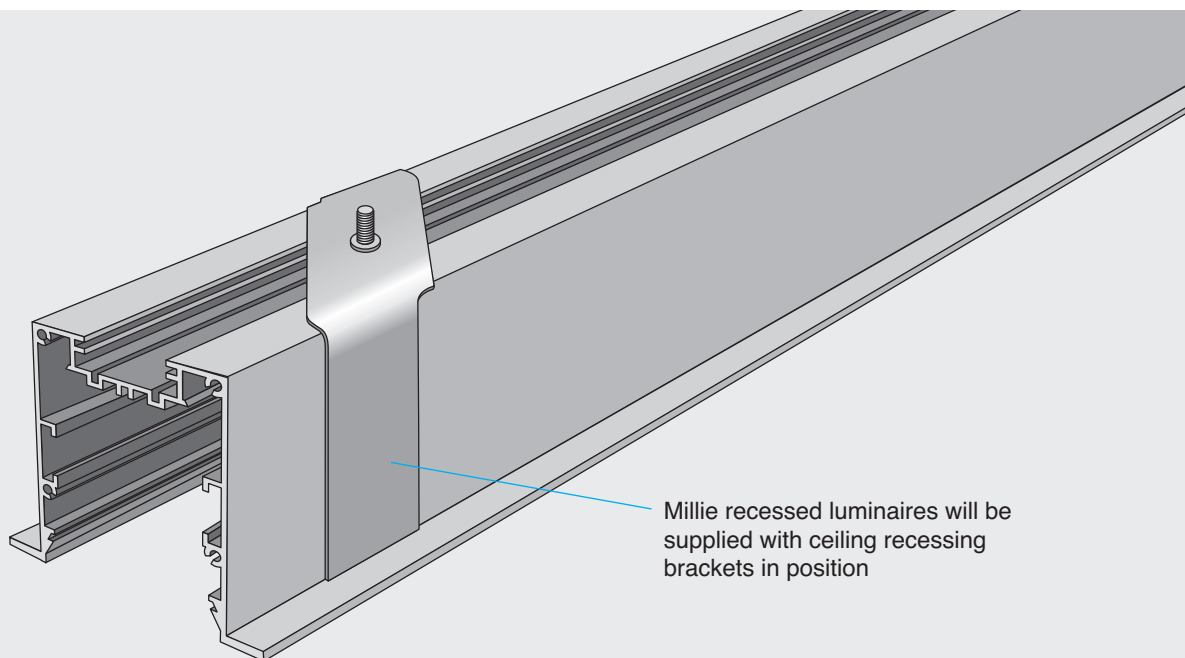
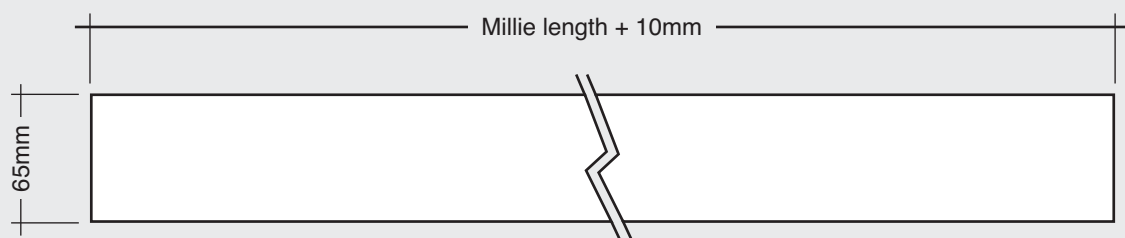

**MILLIE - LINEAR LED LUMINAIRE**  
**Installation instructions**



## Recessed

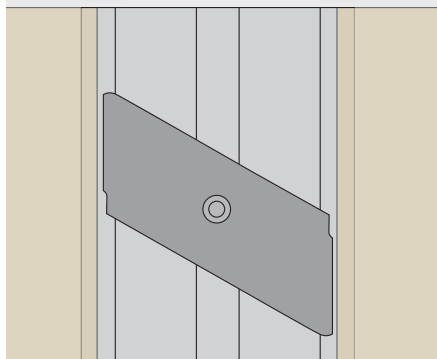
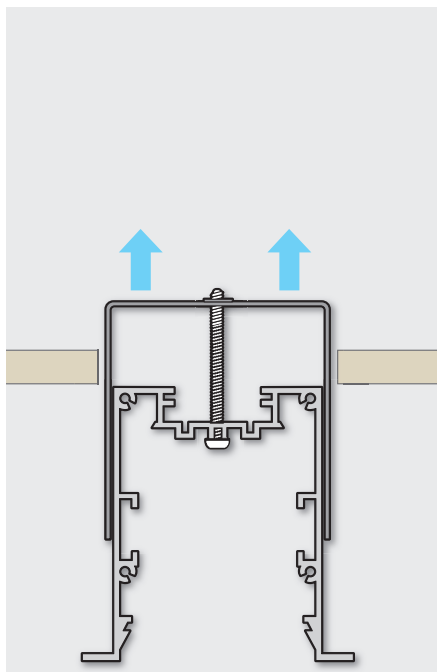

Insert Millie in to ceiling cut out with brackets tight against luminaire.

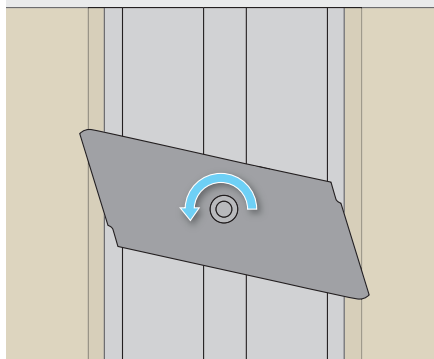
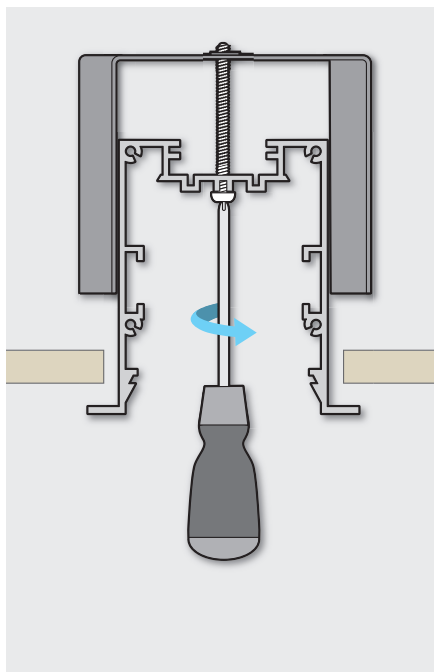

Using screwdriver, push screw up and begin to tighten screw.

The bracket will open up and begin to pull down on to the plasterboard.

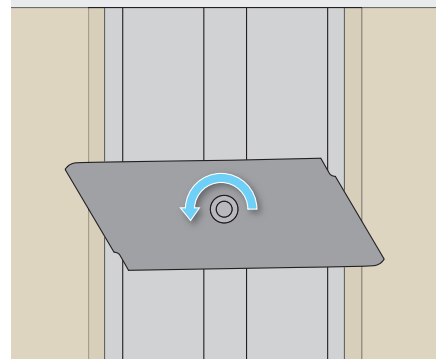
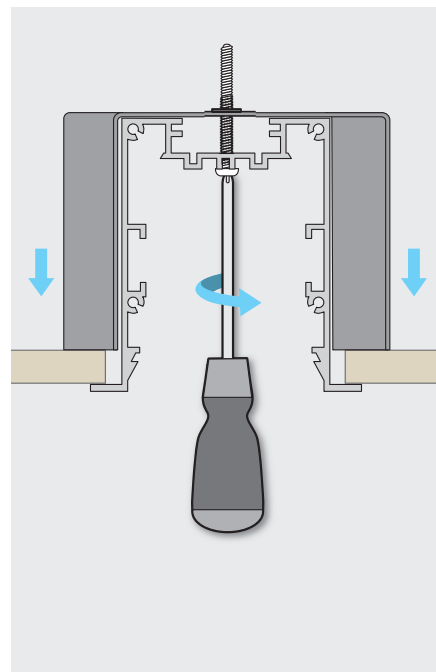

Ensure luminaire is tight in the ceiling and not loose.

**Innovation.**  
**Collaboration.**  
**Illumination.**





## Removing LED

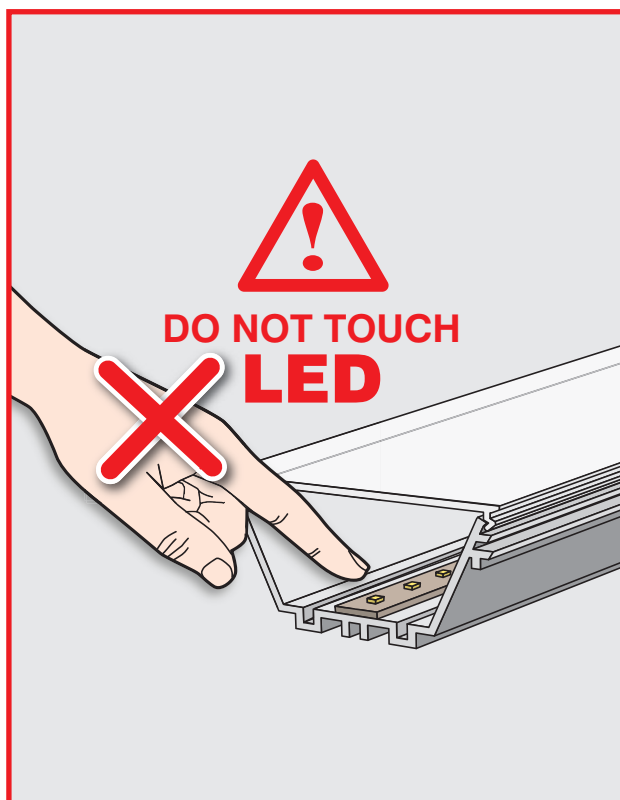
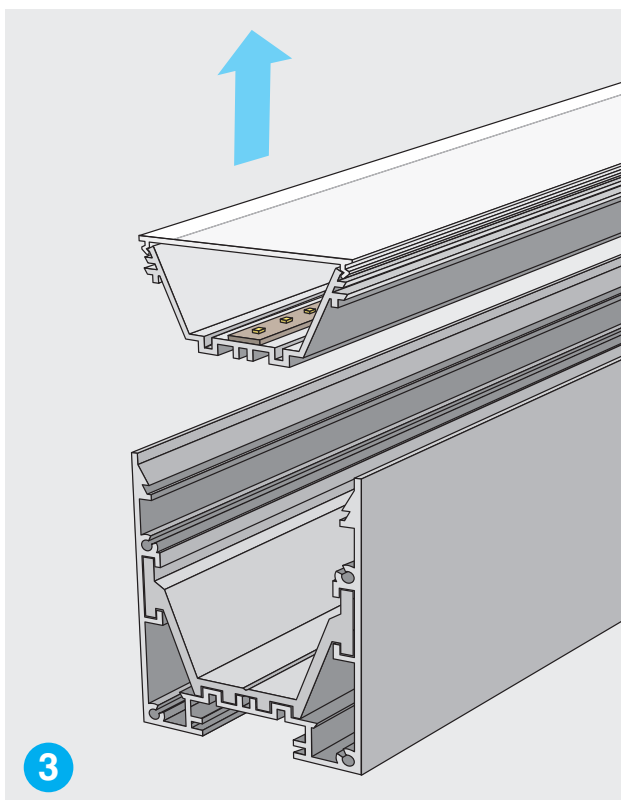
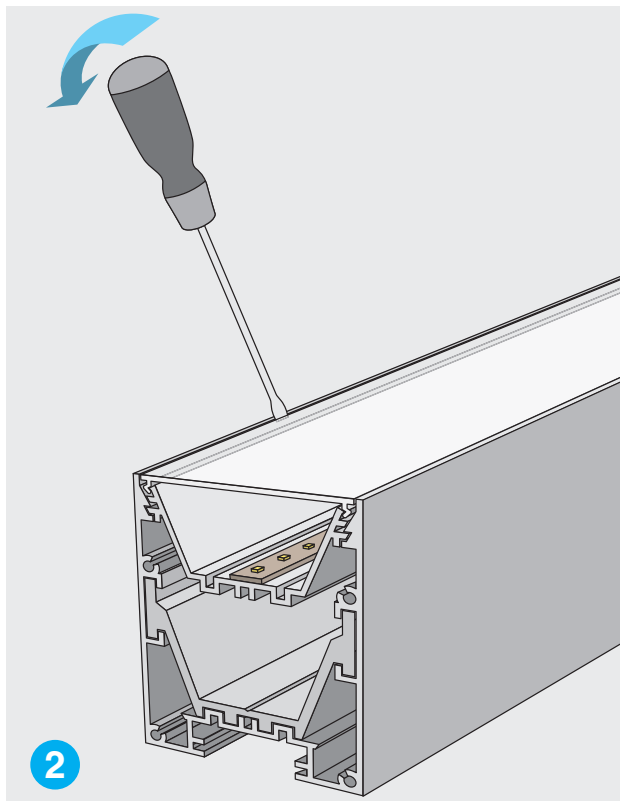
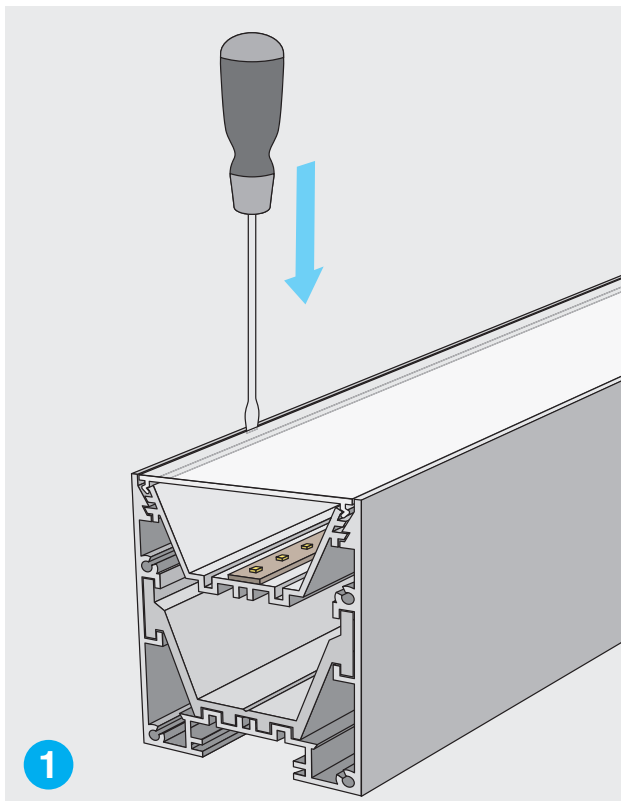



## Connecting multiple units

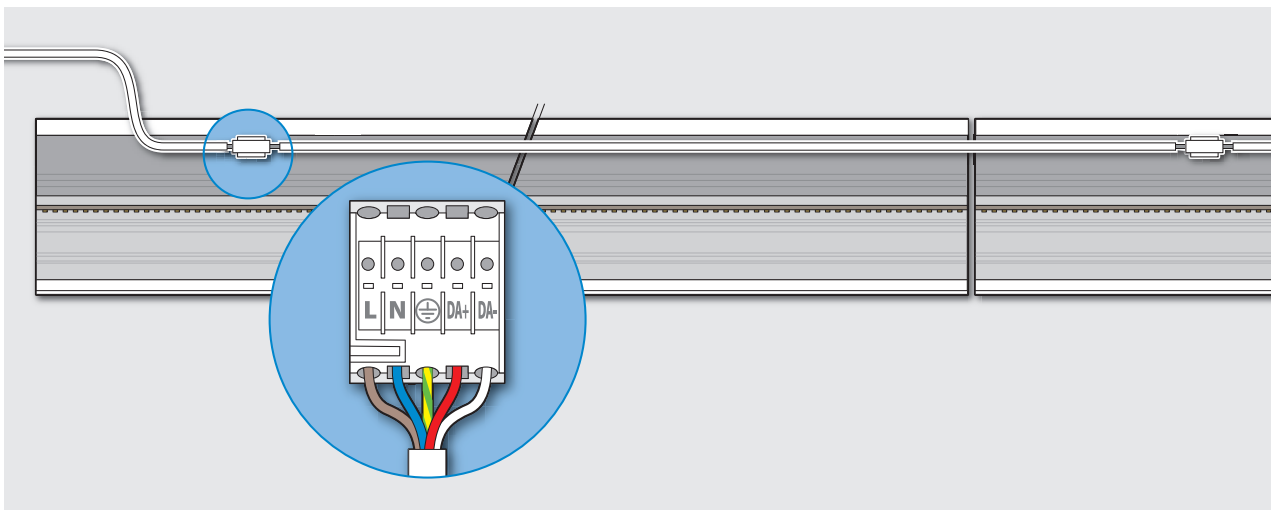

## Connecting with coupler

